

# مباني مواقف السيارات Car parking buildings



المرشد للمقاولات و البريكاست  
ALMARSHAD CONTRACTING & PRECAST



إحدى شركات Members of

المرشد القابضة  
ALMARSHAD HOLDING



[www.almarshad.com](http://www.almarshad.com)





المرشد للمقاولات و البريكاست  
ALMARSHAD CONTRACTING & PRECAST



Members of إحدى شركات

المرشد القابضة  
ALMARSHAD HOLDING



منذ عام ١٩٦٩م

Since 1969



# مواقف متعددة الادوار موظفي امانة منطقة عسير

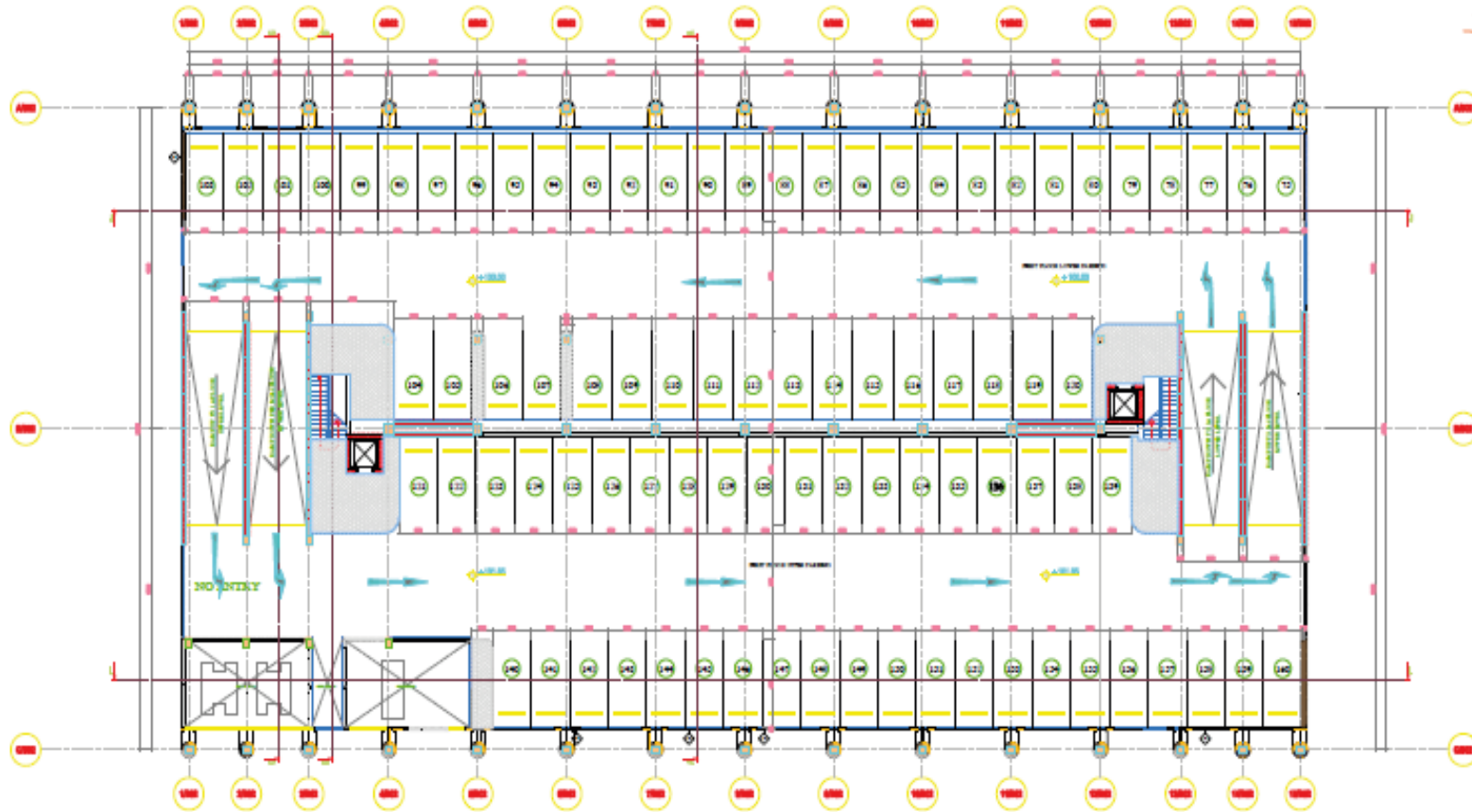

FIRST FLOOR CARPARKING PLAN

NOTE:  
 1. ALL DIMENSIONS ARE IN MILLIMETER AND LEVELS ARE IN METERS UNLESS OTHERWISE NOTED.  
 2. DO NOT SCALE THE DRAWING FOR ANY DIMENSION CLARIFICATION ASK THE ENGINEER.

Total Car Parking = 330nos.  
 3 Floor+ROOF Total Area = 11990 m2

AS BUILT

NO.	DESCRIPTION	DATE	BY

المملكة العربية السعودية  
 KINGDOM OF SAUDI ARABIA  
  
 وزارة الداخلية  
 امانة منطقة عسير

PROJECT NAME: **ASIAE CARPARKING**

CONSULTANT:  
  
**AL MARSHAD PRECAST COORDINATION**

NO.	AREA	DATE	REVISION	REVISION	REVISION

CONTRACTOR FOR PRECAST ELEMENTS:  
  
**ALMARSHAD GROUP CONTRACTING COMPANY**

DWG. TITLE: **FIRST FLOOR CARPARKING PLAN**

DRAWN BY: LITHRA	DESIGNED BY: ENGR. ABDO MANSOUL
CHECKED BY: ENGR. ABDO	CHECKED BY: ENGR. ABDO MANSOUL
DATE: 11-03-2019	APPROVED BY: ENGR. ABDO MANSOUL
PROJECT NO.:	REV. STATUS
DWG. NO.:	0 0A

KSA-SD-AR-02



مواقف إمارة منطقة عسير  
Positions of the Emirate of Asir region

# مواقف متعددة الدورار فى القوات الجوية

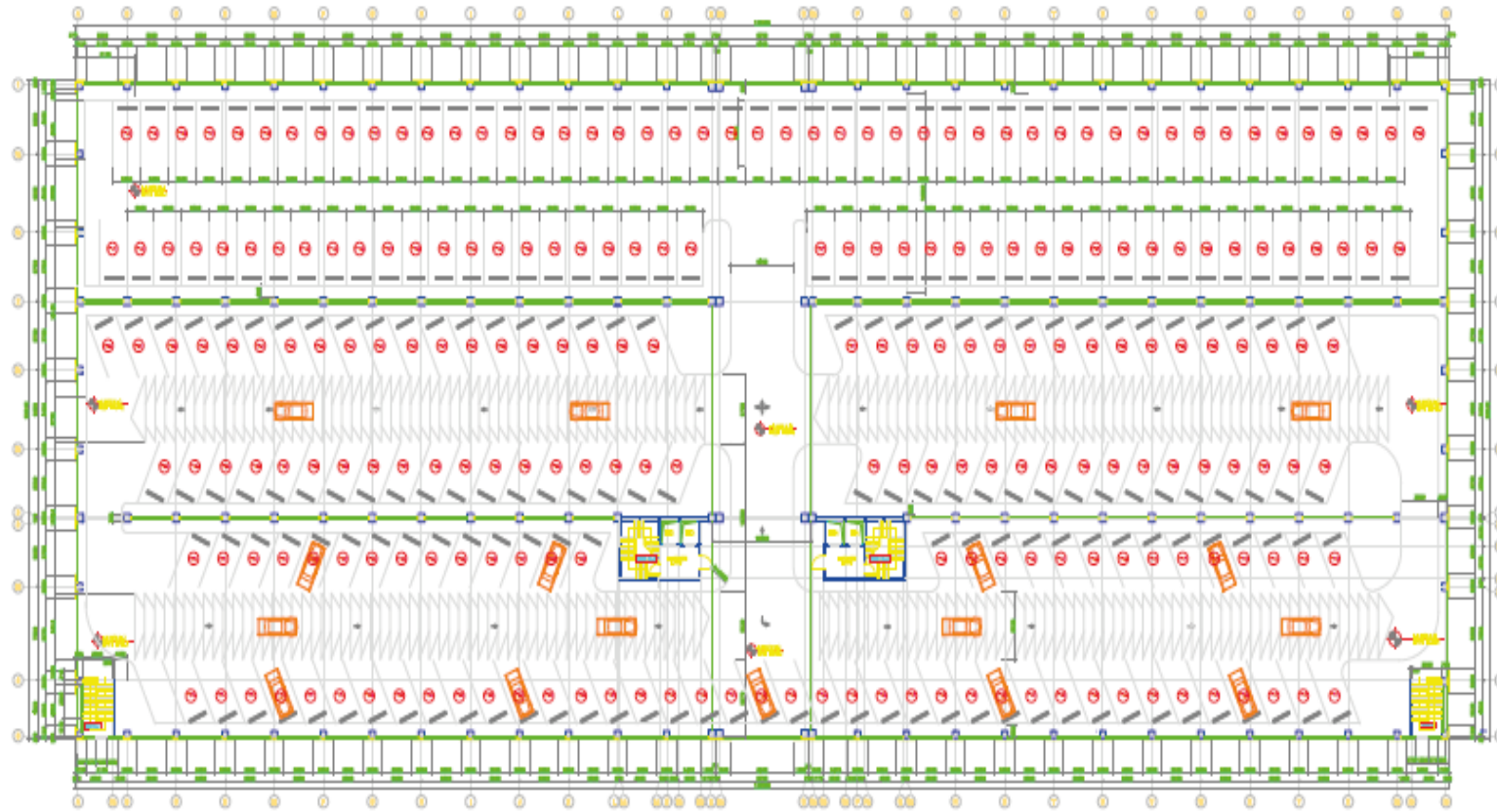

FIRST LEVEL LAYOUT PLAN

**NOTE**

1. ALL DIMENSIONS ARE IN MILLIMETER AND LEVELS ARE IN METERS UNLESS OTHERWISE NOTED.
2. DO NOT SCALE THE DRAWING. FOR ANY DIMENSION CLARIFICATION, ASK THE ENGINEER.



Total Car Parking = 1255 nos.  
5 Floor Total Area = 348270 m<sup>2</sup>

AS BUILT

NO.	REVISION	DATE	BY

 المملكة العربية السعودية  
 وزارة الدفاع والوقاية المدنية  
 القوات الجوية الملكية السعودية  
 KINGDOM OF SAUDI ARABIA  
 MINISTRY OF DEFENSE AND CIVILIAN PROTECTION  
 SAUDI ARAB AIR FORCE

PROJECT NAME: **MULTI CAR PARKING IN ROYAL SAUDI AIR FORCE HEAD QUARTER**

CONTRACTOR:  
  
**AL MARSHAD PRECAST COORDINATION**

NO.	DATE	STATUS	REVISION	REVISION	REVISION

CONTRACTOR FOR PRECAST ELEMENTS:  
 شركة مجموعة المارشاد  
**ALMARSHAD GROUP**  
 CONTRACTING COMPANY

DWG TITLE: **FIRST LEVEL PLAN LAYOUT**

DRAWN BY: JAMAL	DESIGNED BY: ENGR. ABDO MARSHOUL
CHECKED BY: JACK	CHECKED BY: ENGR. ABDO MARSHOUL
DATE: 2011-11-20	APPROVED BY: ENGR. ABDO MARSHOUL
PROJECT NO. S.A.F.AR-01	REV. STATUS
DWG NO. S.A.F.AR-01	0 PA



مواقف القوات المسلحة  
Positions of the armed forces

# انشاء المواقف الجديدة بمدينة الأمير سلطان الطبية العسكرية

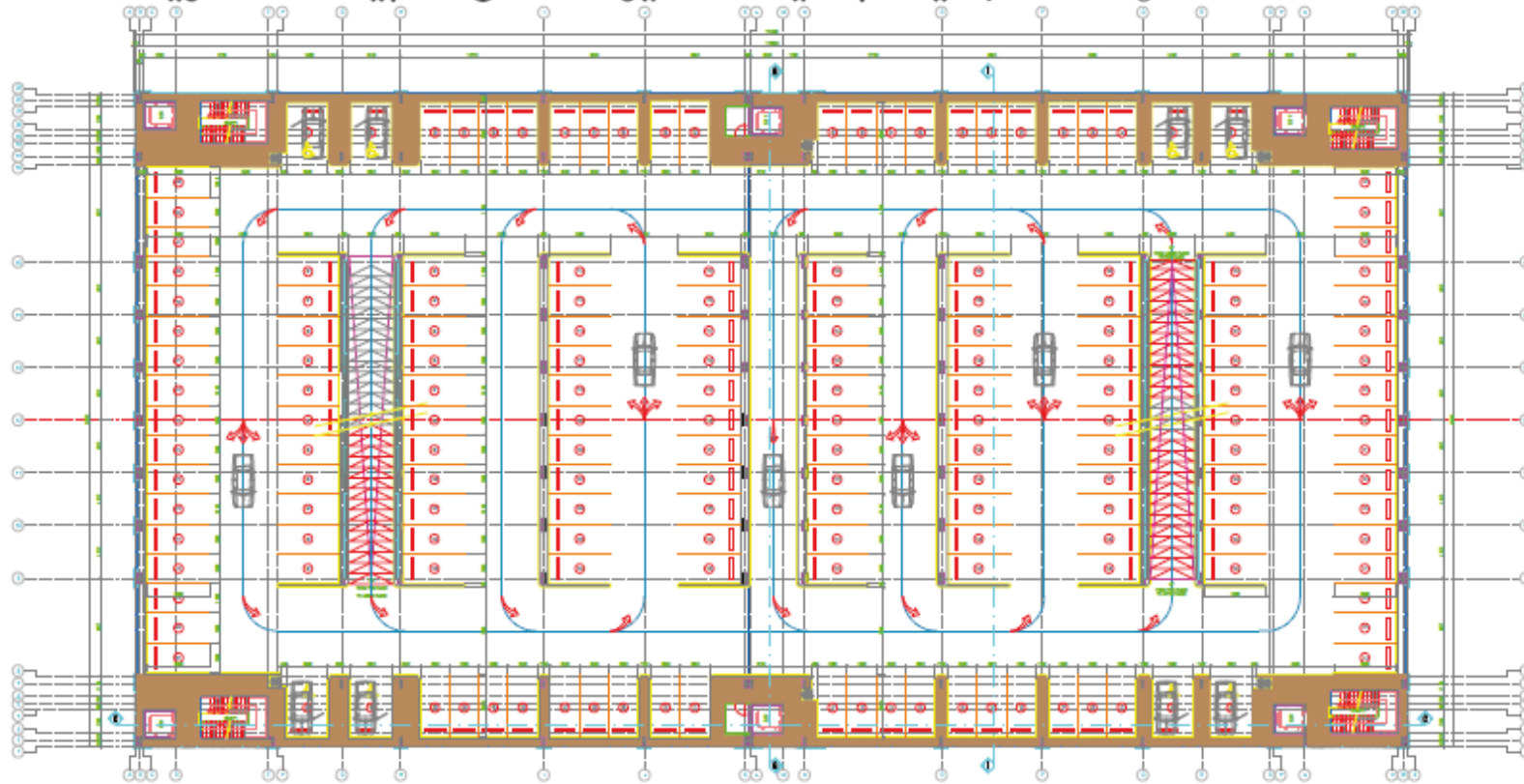

1 FIRST FLOOR TO 4TH FLOOR PLAN

NOTE:  
 1. ALL DIMENSIONS ARE IN MILLIMETER AND LEVELS ARE IN METERS UNLESS OTHERWISE NOTED.  
 2. DO NOT SCALE THE DRAWING. FOR ANY DIMENSION CLARIFICATION ASK THE ENGINEER.



Total Car Parking = 1164 nos.  
 2 BASEMENT+5 FLOOR  
 Total Area = 40000 m2

AS BUILT

NO.	FOR APPROVAL	DESCRIPTION	DATE	ISSUED BY

CUSTOMER:  
 KINGDOM OF SAUDI ARABIA  
 MINISTRY OF DEFENCE  
 MEDICAL SERVICES DEPARTMENT  
 RIYADH

PRINCE SULTAN  
 MILITARY MEDICAL CITY  
 ENGINEERING SERVICE DEPT.



PROJECT NAME:  
**NEW CAR PARKING PROJECT**  
**PRINCE SULTAN MILITARY MEDICAL CITY**

CONTRACTOR:  
 AL MARSHAD PRECAST COORDINATION

NO.	APPL.	ISSUE	REVISION	REMARK	DATE

CONTRACTOR FOR PRECAST ELEMENTS:  
 شركة المجمعة للمقاولات  
 ALMARSHAD GROUP  
 CONTRACTING COMPANY



DRAW TITLE:  
**FIRST FLOOR TO 4TH FLOOR PLAN**

DRAWN BY: UTHAIL	CHECKED BY: ENGR. AHMED MARSHAD
CHECKED BY: ENGR. AHMED	CHECKED BY: ENGR. AHMED MARSHAD
DATE: 8-11-2016	APPROVED BY: ENGR. AHMED MARSHAD
PROJECT NO. 14 FOR APPROVAL	FOR MODIFICATION
DRAW. NO. AR_05	SHEET NO. 01





مواقف مدينة الامير سلطان الطبية العسكرية  
Prince Sultan Military Medical City Cars Parking

# مواقف متعددة الدورار في مشفى الملك عبد العزيز الجامعى الرياض-الملز

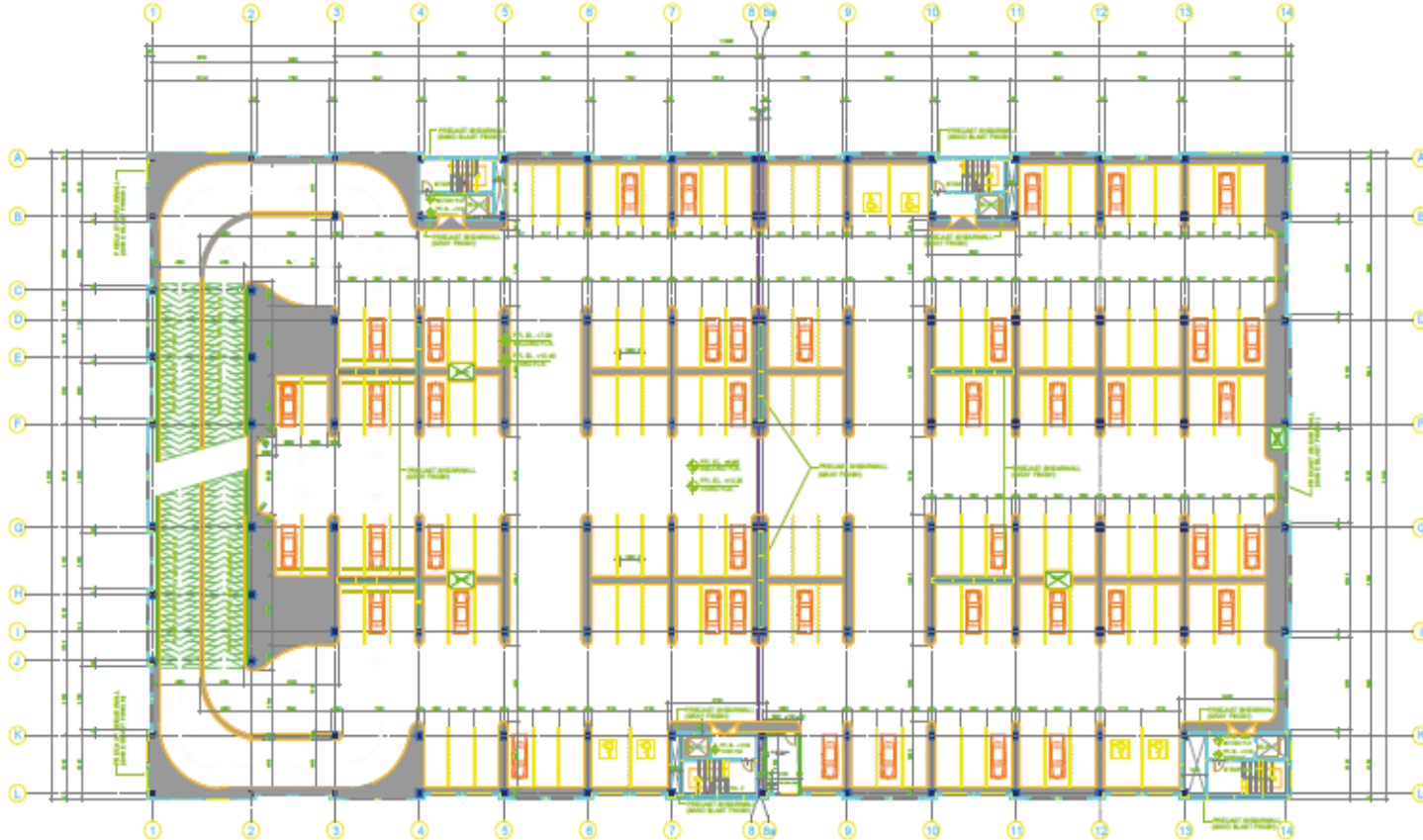

SECOND & THIRD FLOOR PLAN  
15/07/13

NOTE:  
1. ALL DIMENSIONS ARE IN MILLIMETER AND LEVELS ARE IN METERS UNLESS OTHERWISE NOTED.  
2. DO NOT SCALE THE DRAWING. FOR ANY DIMENSION CLARIFICATION ASK THE ENGINEER.



Total Car Parking = 1400 nos.  
8 Floor+Roof Total Area = 5998 m<sup>2</sup>

NO.	FOR APPROVAL	DATE	BY



King Saud University

جامعة الملك سعود  
الرياض - المملكة العربية السعودية

مشروع الرياض - مستشفى الملك عبد العزيز الجامعى  
مواقف متعددة الدورار

CONSULTANT  
SAUDI CONSOLIDATED  
ENGINEERING CO.  
KHATTIB & ALAMI  
P.O. BOX 9228, RIYADH-11481  
TELEPHONE NO. 91477 9384  
FAX NO. 91477 9393



شركة الاتحاد الهندسي السعودية  
الرياض و طلي  
ص.ب: الرياض 11481  
هاتف: 91477 9384  
فاكس: 91477 9393

NO.	DATE	STATUS	REVISION	REMARKS

CONTRACTOR FOR PRECAST CONCRETE  
شركة مجموعة المرشاد  
ALMARSHAD GROUP  
CONTRACTING COMPANY



PROJECT TITLE  
MULTI STOREY CAR PARKING  
SECOND & THIRD FLOOR PLAN

DRAWN BY: JACK JAWAN      CHECKED BY: ENGR. ASOUD MANSOUR  
DESIGNED BY: ENGR. ASOUD      CHECKED BY: ENGR. TARIQ M. GAWRYAN  
DATE: 15-07-13      SCALE: 1:100      APPROVED BY:

PROJECT NO.	REV. FOR APPROVAL	REV. FOR PRODUCTION	REV. PRELIMINARY

DWG. NO. AR-05



مواقف مستشفى الملك عبدالعزيز الجامعي / الرياض  
King Abdulaziz University Hospital car parking / Riyadh

# مواقف المركز الطبي في جامعة الملك عبد العزيز- جدة

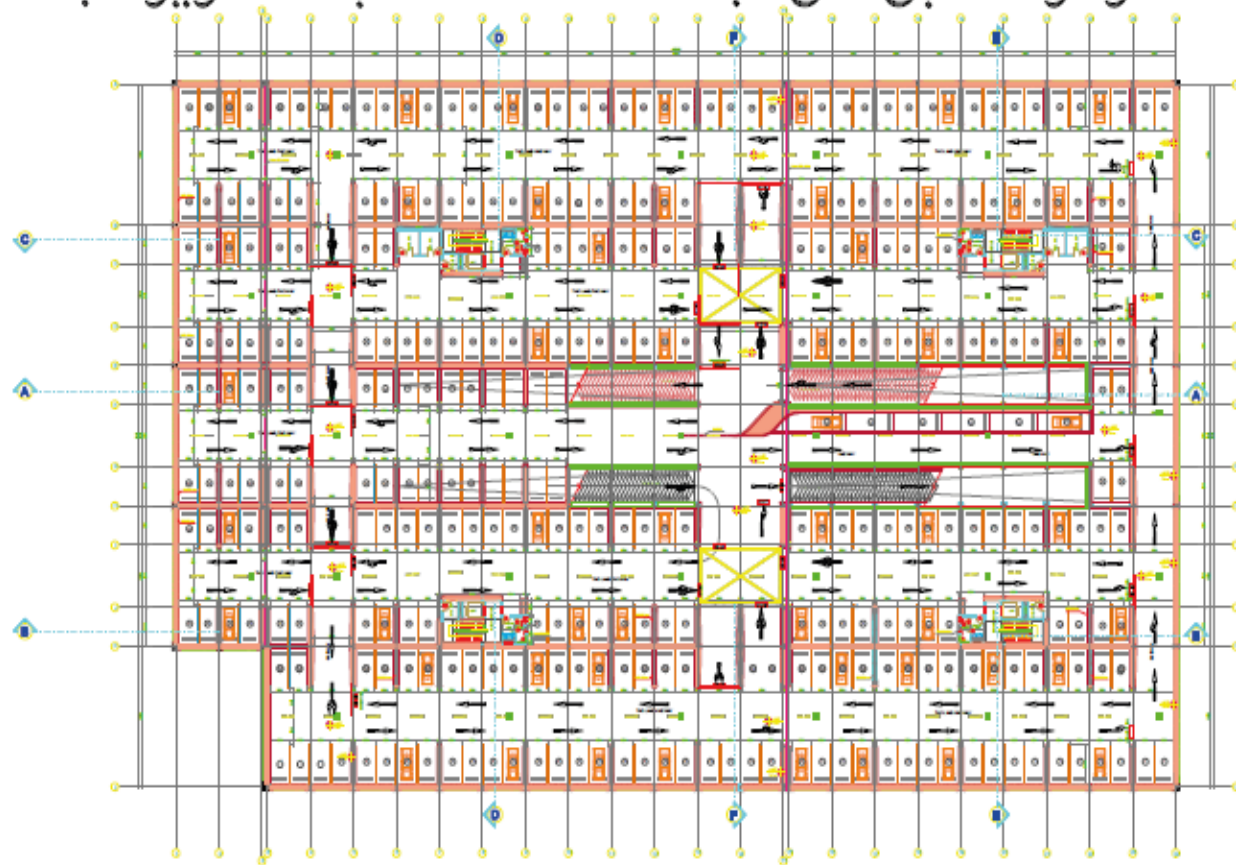

FIRST FLOOR TRAFFIC FLOW PLAN

NOTE:  
 1. ALL DIMENSIONS ARE IN MILLIMETER AND LEVELS ARE IN METERS UNLESS OTHERWISE NOTED.  
 2. DO NOT SCALE THE DRAWING. FOR ANY DIMENSION CLARIFICATION ASK THE ENGINEER.

Total Car Parking = 980 nos.  
 2 Floor+Roof Total Area = 25000 m<sup>2</sup>



DESIGN APPROVAL	14.01.2014	A. NEMECOLU
REVISED AS PER CONSULTANTS COMMENTS	26.11.2013	M. KHAN
REVISED AS PER CONSULTANTS COMMENTS	26.10.2013	M. KHAN
DESIGN APPROVAL	08.7.2013	F. HADJI
TENDER DESIGN APPROVAL	12.1.2013	F. HADJI
REV.	DESCRIPTION	DATE

  
**KING ABDULAZIZ UNIVERSITY**  
 جامعة الملك عبدالعزيز  
 PROJECTS DIRECTORATE  
 JEDDAH  
 KINGDOM OF SAUDI ARABIA

**KAU MEDICAL CENTER**  
 MULTI STOREY CAR PARKING

**FLUOR**  
 FLUOR ARABIA LIMITED  
 KING ABDULAZIZ UNIVERSITY PROJECT  
 JEDDAH

AL MARSHAD PRECAST COORDINATION				
ARCH	STRUCT	METALL	MESHING	FINISHING

CONTRACTOR FOR PRECAST ELEMENTS:  
  
**ALMARSHAD GROUP**  
 CONTRACTING COMPANY

**FIRST FLOOR TRAFFIC FLOW PLAN**

DESIGN BY:	A. NEMECOLU	DESIGNED BY:	ENGR. ASAD MASHOOL
CHECKED BY:	ENGR. ASAD	DESIGNED BY:	ENGR. TARIQ M. QANAYRAH
DATE:	26.01.14	SCALE:	1:100
PROJECT NO.		APPROVED BY:	
DWG. NO.	M2-KAU-P(2)-AR-15	DATE:	27.01.14



مواقف المركز الطبي في جامعة الملك عبدالعزيز / جدة  
Medical center at King Abdulaziz University Car Parking / Jeddah

# مواقف متعددة الادوار في جامعة الملك عبد العزيز-جدة

NOTE:  
 1. ALL DIMENSIONS ARE IN MILLIMETER AND LEVELS ARE IN METERS UNLESS OTHERWISE NOTED.  
 2. DO NOT SCALE THE DRAWING FOR ANY DIMENSION CLARIFICATION ASK THE ENGINEER.

Total Car Parking = 984 nos.  
 2 Floor+Roof Total Area = 25000 m<sup>2</sup>

Key Plan

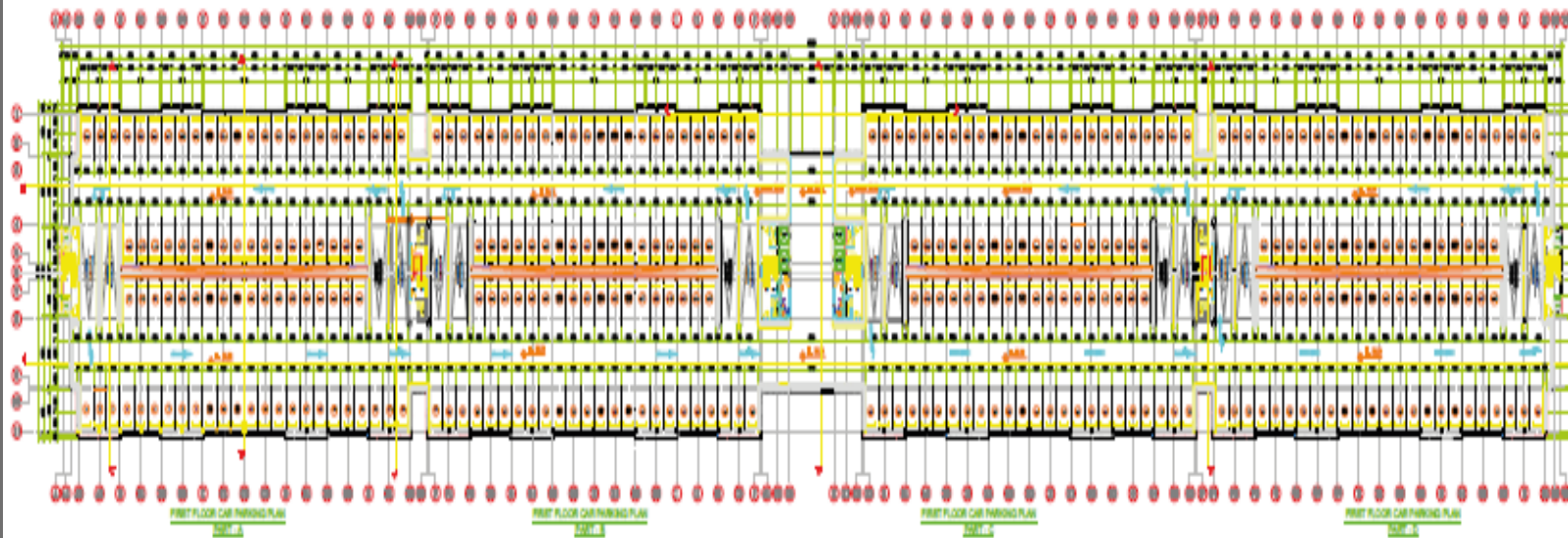
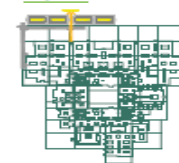

FIRST FLOOR CAR PARKING PLAN

FOR APPROVAL	DATE	SIGNATURE
FOR APPROVAL	08-10-2011	LITANA
FOR APPROVAL	DATE	BY

**KING ABDULAZIZ UNIVERSITY**  
 PROJECTS DIRECTORATE  
 JEDDAH  
 KINGDOM OF SAUDI ARABIA

**MULTI STOREY CAR PARKING**

**FLUOR**  
 FLUOR ARABIA LIMITED  
 KING ABDULAZIZ UNIVERSITY PROJECT

**AL MARSHAD PRECAST COORDINATION**

NO.	AKL	ENGR	MECH	MECH	PLUMB
01					

CONTRACTOR FOR PRECAST ELEMENTS:  
**شركة مجموعة المرشاد**  
**ALMARSHAD GROUP**  
 CONTRACTING COMPANY

PROJECT TITLE: **FIRST FLOOR CAR PARKING PLAN**

DESIGNED BY: LITANA	DRAWN BY: ENGR. ABDO MANSOUR
CHECKED BY: ENGR. ABDO	APPROVED BY: ENGR. ABDO MANSOUR
DATE: 30-01-11	SCALE: 1:100
PROJECT NO.:	FOR APPROVAL / FOR PRODUCTION / PRELIMINARY
20131	DWG. NO. <b>KAU-SD-AR-02B</b>



مواقف جامعة الملك عبدالعزيز / جدة  
King Abdulaziz University Car Parking / Jeddah

# مواقف توسعة مستشفى الملك خالد الجامعي بجامعة الملك سعود

**NOTE**

- ALL DIMENSIONS ARE IN MILLIMETER AND LEVELS ARE IN METERS UNLESS OTHERWISE NOTED.
- DO NOT SCALE THE DRAWING FOR ANY DIMENSION CLARIFICATIONS ASK THE ENGINEER.

Total Car Parking = 1281nos.  
 2Basement+5Floor+ROOF  
 Total Area =49080 m2

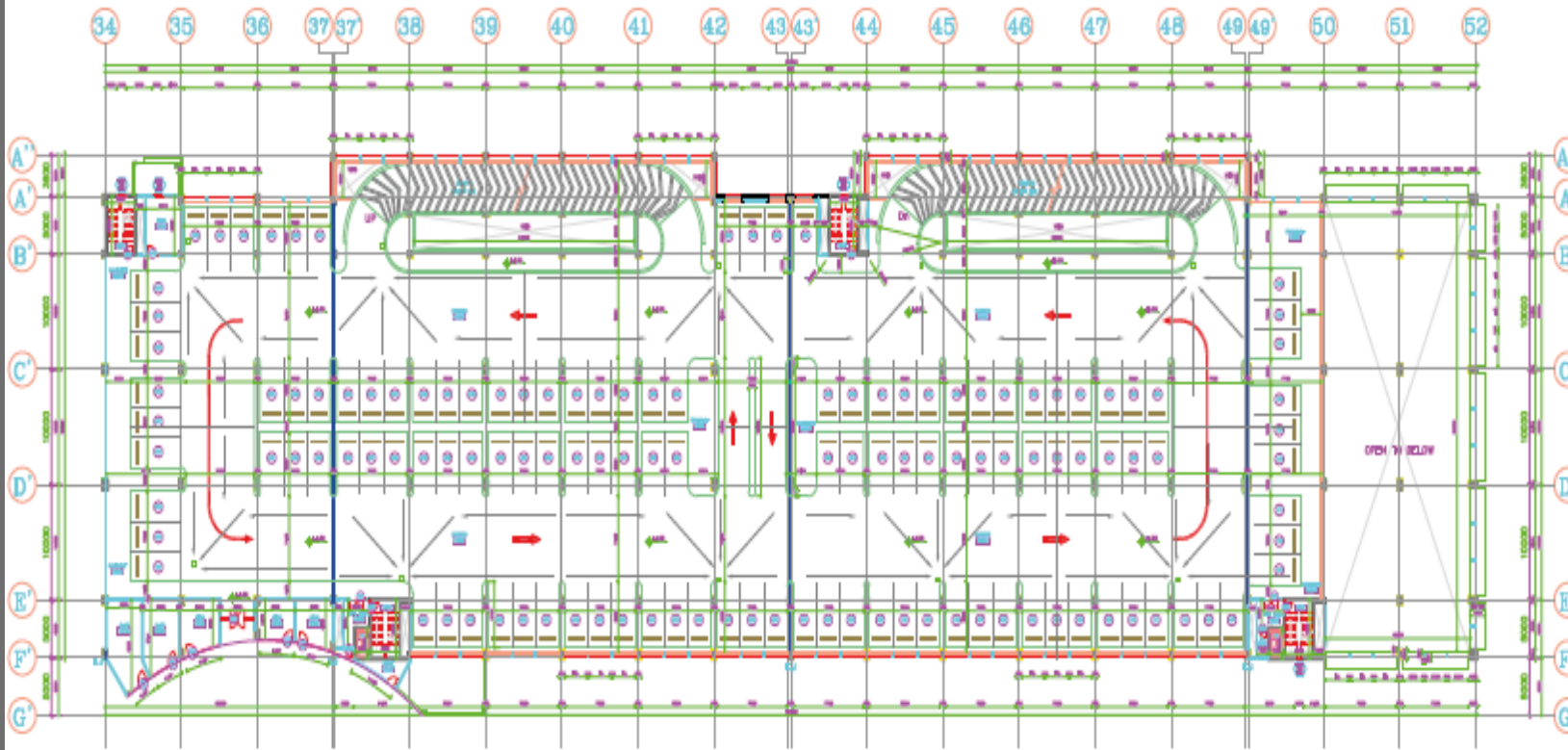

LEVEL-1 PLAN



NO.	DESCRIPTION	DATE	BY

King Saud University  
 جامعة الملك سعود  
 المملكة العربية السعودية

PROJECT NAME  
 King Fahd University Hospital Extension  
 PHASE 1: PARKING BUILDING

GENERAL CONTRACTOR:  
**Bin-SAMMAR EST.**  
 شركة بن سمار للتجارة والبناء

AL MARSHAD PRECAST COORDINATION

NO.	ADD.	STAGE	DESCRIPTION	ISSUANCE	REMARKS

CONTRACTOR FOR PRECAST ELEMENTS:  
 شركة المشهد للخرسانة الجاهزة  
**ALMARSHAD GROUP**  
 CONTRACTING COMPANY

DWG. TITLE: LEVEL-1 PLAN

DESIGN BY: AL MARSHAD	DRAWN BY: ENGR. ABDO MURAD
CHECKED BY: ENGR. ABDO	OVERSEEN BY: ENGR. TARIQ M. QANAYAN
DATE:	APPROVED BY:
PROJECT NO.	NO. FOR APPROVAL
DWG. NO.	NO. FOR PRODUCTION
	NO. PRELIMINARY
	NO. STATUS





مواقف مستشفى الملك خالد الجامعي / الرياض  
King Khalid University Hospital Car Parking / Riyadh

## مواقف توسعة مبنى التلفزيون

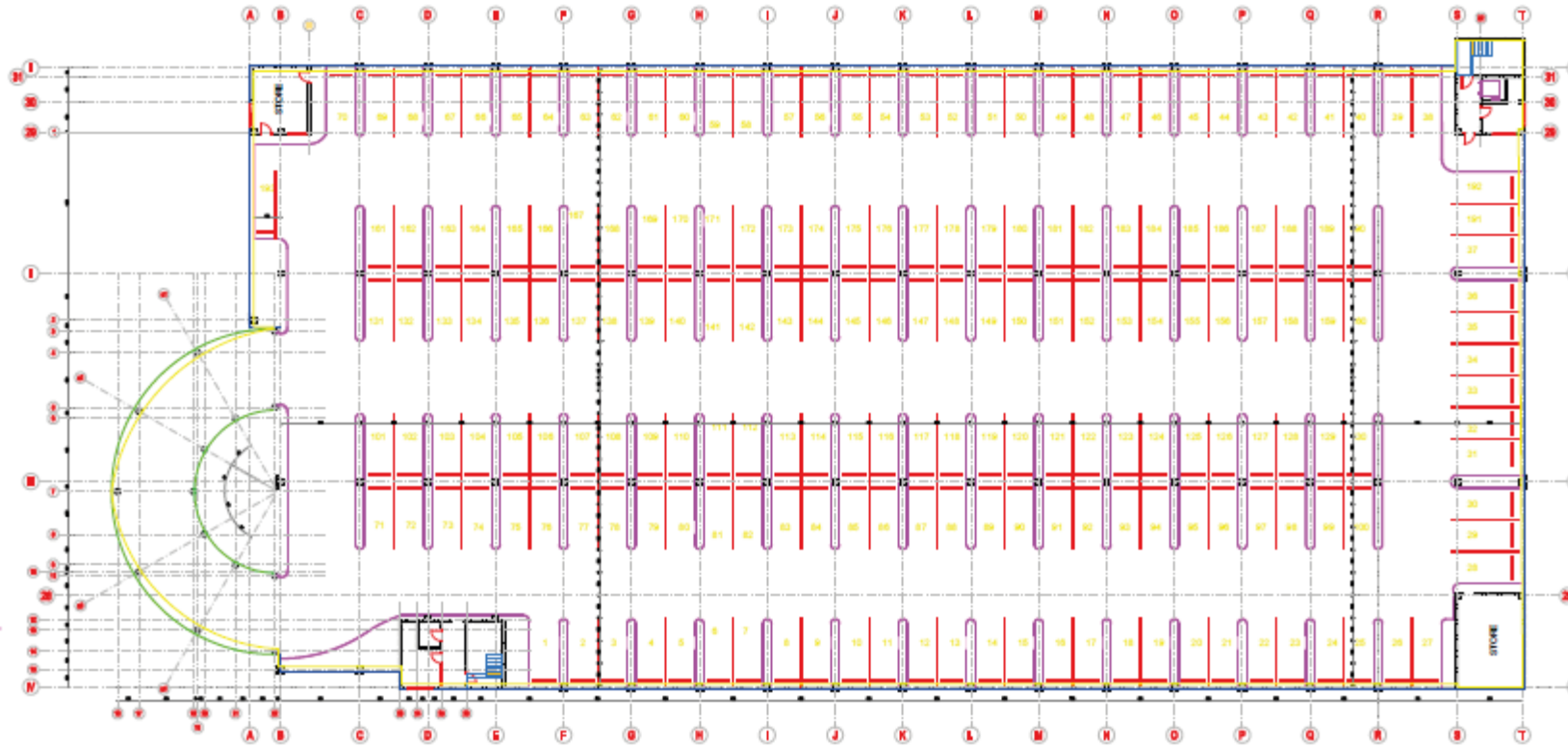

ROOF DECK PARKING PLAN

NOTE  
 1. ALL DIMENSIONS ARE IN MILLIMETER AND LEVELS ARE IN METERS UNLESS OTHERWISE NOTED.  
 2. VERIFY SCALE OF THE DRAWING FOR ANY DIMENSION CLARIFICATION AS THE ENGINEER.

Total Car Parking = 576 nos.  
 2 Floor+Roof Total Area = 12624 m<sup>2</sup>

NO.	REVISION	DATE	BY	CHECKED



MULTI STORY CARPARKING IN  
 RIYADH KINGDOM OF SAUDI ARABIA



NO.	REVISION	DATE	BY	CHECKED

المصراع  
 AL MARSHAD GROUP  
 CONTRACTING COMPANY

### ROOF DECK FLOOR PARKING PLAN LAYOUT

DESIGNED BY: A. SAADULLAH	CHECKED BY: ENGR. MOHAMMED
DRAWN BY: ENGR. AHMED	APPROVED BY: ENGR. TARIQ B. QUTUB
DATE: 2023/05/10	SCALE: 1/200
PROJECT NO.:	NO. FOR PRODUCTION:
DATE:	NO. FOR RELEASE:
AR-TV-CP-002	AR-TV-CP-002



مواقف مبنى التلفزيون / الرياض  
TV building parking / Riyadh





صورة  
PIC.

مواقف كلية السياحة والفندقة / الرياض  
Faculty of Tourism and Hotel Car Parking / Riyadh

# مواقف وزارة المالية - الرياض

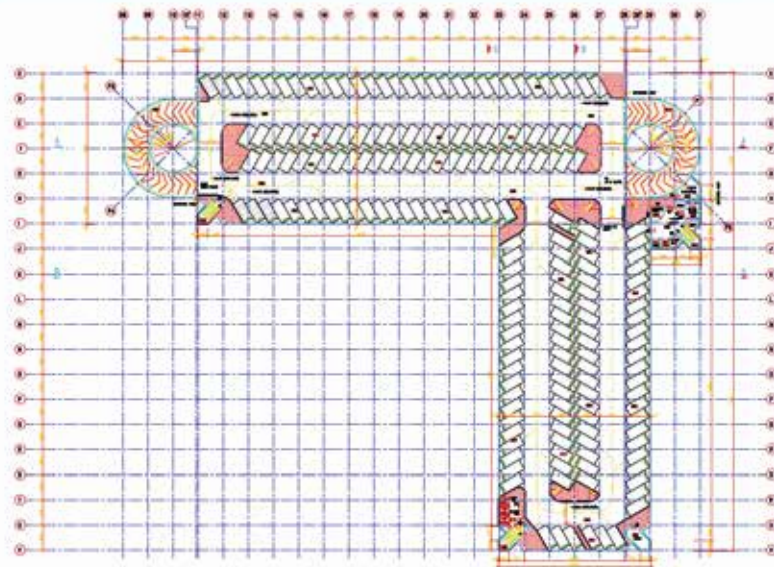

**NOTE:**

1. ALL DIMENSIONS ARE IN MILLIMETER AND LEVELS ARE IN METERS UNLESS OTHERWISE NOTED.
2. DO NOT SCALE THE DRAWING. FOR ANY DIMENSION CLARIFICATION ASK THE ENGINEER.



Total Car Parking = 1010 nos.  
Basement+3Floor+ROOF  
Total Area = 32100 m<sup>2</sup>

NO.	DESCRIPTION	DATE	BY

**CONSULTANT**



**PROJECT NAME**

MULTY STORY CAR PARKING BUILDING IN RIYADH

**AL MARSHAD PRECAST COORDINATION**

NO.	MOD.	STRUCT.	ELECTRICAL	MECHANICAL	PLUMBING

**CONTRACTOR FOR PRECAST ELEMENTS**

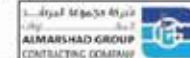

**DWG TITLE**

ROOF FLOOR PLAN

DRAWN BY: AZIZ	DESIGNED BY: ENGR. ABOO MASHOUL
CHECKED BY: ENGR. ABOO	ENGINEER BY: ENGR. TARIQ M. QANAYEM
DATE: 20/04/2018	SCALE: 1:100
PROJECT NO. PA FOR APPROVAL	PP FOR PRODUCTION
DWG NO.	REV. STATUS
	8 PA



# مواقف الخدمات الطبية

مواقف متعددة الطوابق بإدارة الخدمات الطبية

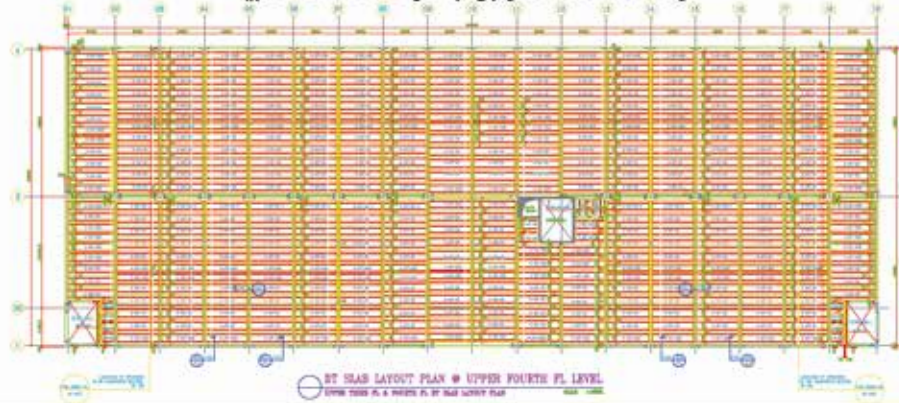

**NOTE:**  
1. ALL DIMENSIONS ARE IN MILLIMETER AND LEVELS ARE IN METERS UNLESS OTHERWISE NOTED.  
2. DO NOT SCALE THE DRAWING. FOR ANY DIMENSION CLARIFICATION ASK THE ENGINEER.

GROUND+4 Floor+Roof  
Total Area = 16458 m<sup>2</sup>

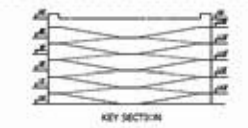

- LEGEND:**
- WED BATH BUILDING
  - GATED WOOD-1
  - GATED WOOD-2
  - GATED WOOD
  - SECURITY ACCOMMODATION
  - CLINICAL WING
  - PATIENTS GENERATOR
  - OPERATING WASHROOM BUILDING
  - CONTRACTORS EXITS
  - LOW PARKING BUILDING
  - EXTENSION WED BUILDING LOW
  - CONCRETE CAR PARKING
  - STAIRWAYS WALL

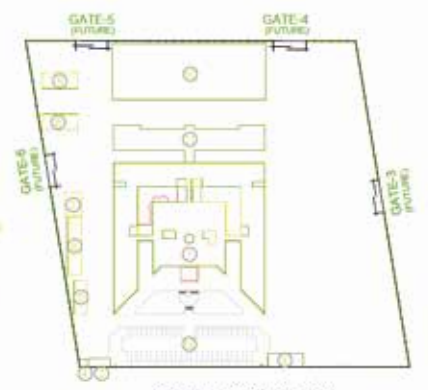

REVISION	NO.	DESCRIPTION	DATE	BY
REMOVED AS PER REQUIRED	17-10-2002	Gayath		
REMOVED AS PER REQUIRED	27-11-2002	Gayath		
ISSUED FOR APPROVAL	13-09-2003	RCM		

CONTRACTOR

**AMEL CONCRETE & INDUSTRIAL CO. LTD.**  
P.O. Box 82888, Riyadh 11588  
Kingdom of Saudi Arabia

PROJECT NAME: **MEDICAL SERVICES DIRECTORATE HEADQUARTER RIYADH, KINGDOM OF SAUDI ARABIA**

CONSULTANT

**مكتب المهندس اوتايبة**  
**Otaiba Engineering Office**  
P.O. Box 82888, Riyadh 11588  
Kingdom of Saudi Arabia

**AL MARSHAD PRECAST COORDINATION**

NO.	REV.	ENCL.	REASON	ISSUED	APPROVED

CONTRACTOR FOR PRECAST ELEMENTS

**شركة مجموعة المارشاد**  
**المشاد**  
**ALMARSHAD GROUP**  
CONTRACTING COMPANY

DWG TITLE: **DT SLAB LAYOUT PLAN @ UPPER FOURTH FL LEVEL**

DRAWN BY: F. CRUZ	DESIGNED BY: ENGR. ABOO MAAHMOUD
CHECKED BY: ENGR. ABOO	CHECKED BY: ENGR. ABOO MAAHMOUD
DATE: 12-08-02	SCALE: 1:100
PROJECT NO: 20131	DWG. NO: 7063B-CP-GA-08

APPROVED BY:

NO.	REV.	STATUS
2	FA	

# مواقف وزارة النقل - الرياض

## مواقف متعددة الطوابق بوزارة النقل



**NOTE:**  
 1. ALL DIMENSIONS ARE IN MILLIMETER AND LEVELS ARE IN METERS UNLESS OTHERWISE NOTED.  
 2. DO NOT SCALE THE DRAWING FOR ANY DIMENSION. CLARIFICATION ASK THE ENGINEER.

NO.	DESCRIPTION	DATE	BY

OWNER:

PROJECT NAME:  
**MINISTRY OF TRANSPORTATION**

CONSULTANT:  
**AL MARSHAD PRECAST COORDINATION**

REV.	AM.	ENGR.	DATE	BY

CONTRACTOR FOR PRECAST ELEMENTS:  
  
**ALMARSHAD GROUP CONTRACTING COMPANY**

DWG TITLE:  
**GOOGLE EARTH PERSPECTIVE VIEW**

DESIGNED BY:	ENGR. ABDO MAHMOUD
CHECKED BY:	ENGR. ABDO MAHMOUD
DATE:	SCALE: NTS
APPROVED BY:	ENGR. ABDO MAHMOUD
PROJECT NO.:	REV. STATUS
DWG NO.:	0 PA





المرشد للمقاولات و البريكاست  
ALMARSHAD CONTRACTING & PRECAST



Members of إحدى شركات

المرشد القابضة  
ALMARSHAD HOLDING



منذ عام ١٩٦٩م

Since 1969





طول البيم ٢٥ متر  
Pem length is 25 meters



## المرشد للمقاولات و البريكاست ALMARSHAD CONTRACTING & PRECAST



إحدى شركات Members of

المرشد القابضة  
ALMARSHAD HOLDING



الإدارة العامة ، الرياض ، طريق التخصصي ، هاتف ٥٥٦٦ ٤٧٠ ٩٦٦١ + فاكس ٥٢٨٠ ٤٧٠ ٩٦٦١ +  
Haed Office , Riyadh , Takasosi Rd. Tel. +966 1 470 5280 Fax +966 1 470 5566

[www.almarshad.com](http://www.almarshad.com)

